

eo – charging points, Rose Cottage Car Park

The car charging points are at - <https://w3w.co/method.prom.whirlpool>

These are 7kWh type 2 chargers.

There is a £1+VAT connection charge and then the cost is £3.05 + VAT /hr with a maximum charge period of 24 hours after which time the session will end. You will be charged financially all the time the unit is plugged in even once it has finished supplying electricity, so please do bear this in mind as disconnect and move your car as soon as possible.

Steps to charge your EV.

- 1) You may find it easier to carry out the registration and loading of information before arriving at site whilst connected to wifi as the mobile signal is intermittent in the car park. Firstly, Download the eo App from your App store if you do not already have it.

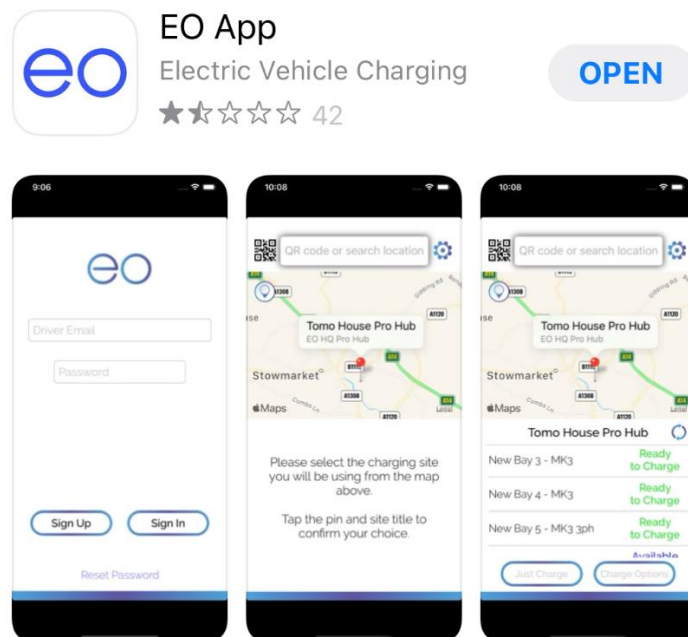

- 2) You will need to register for an account, agree the terms and conditions and then authorise the account by clicking in the confirmation email (sent to the email address you registered with).

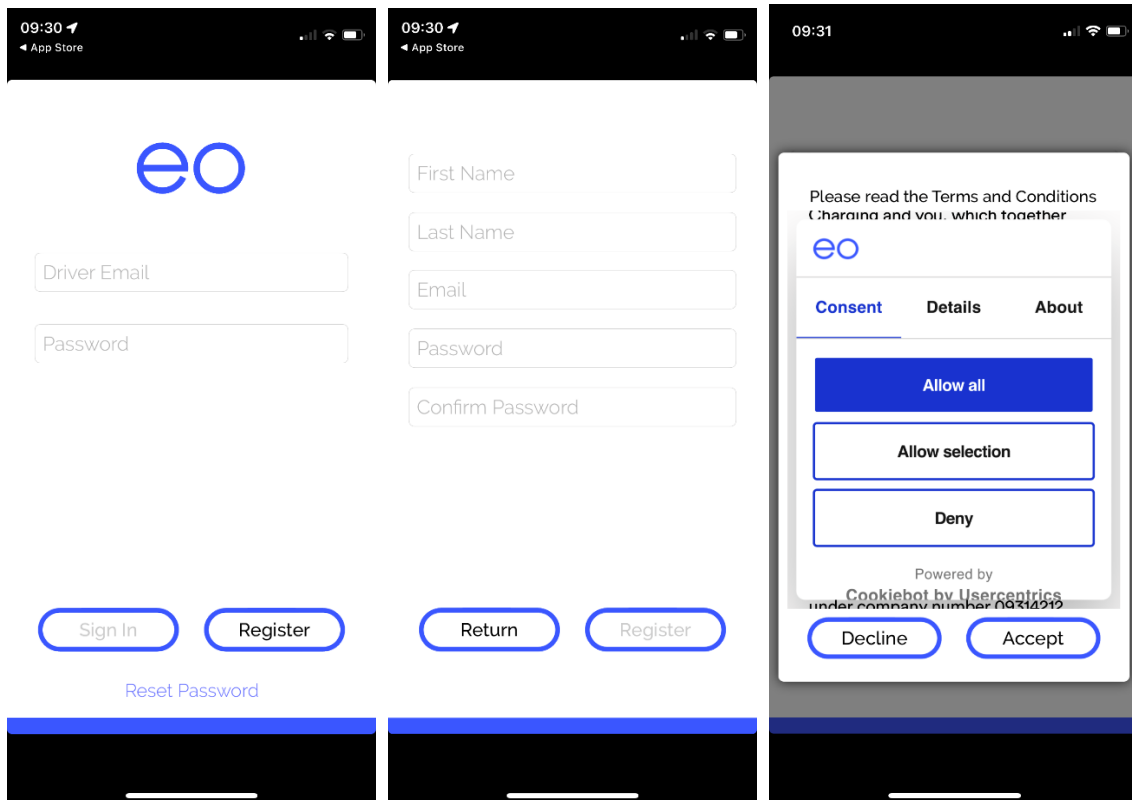

3) You will need to register a credit or debit card

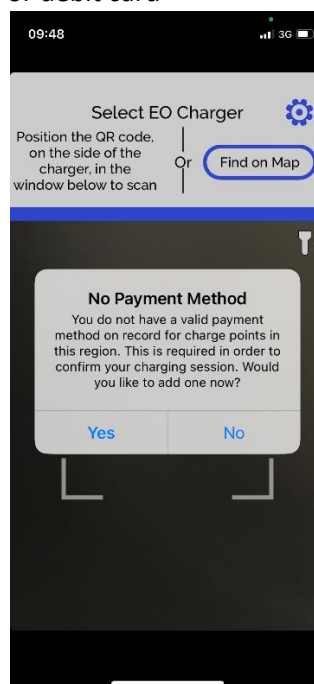

4) Once you have registered your details you then need to connect your ev to charge point with your charging cable, please make sure this is firmly connected at both ends.

- 5) Then scan the QR code on the right hand side of the charge point. This will load the details of the location and ask if you wish to continue. If you do wish to continue select 'OK'.

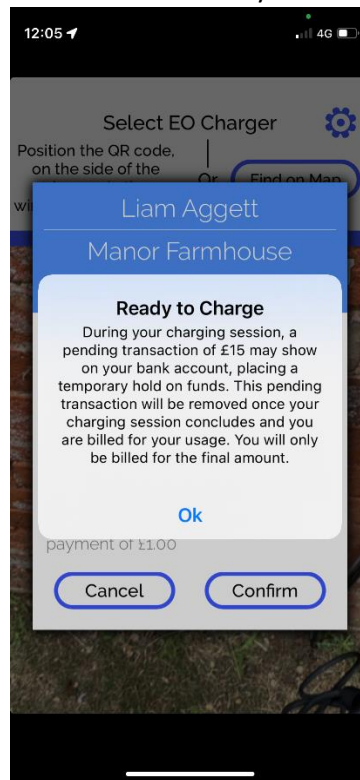

- 6) To finish your charging session please just disconnect your charging cable. You will then be sent an itemised email to your registered email address.

Troubleshooting

If the session won't start make sure your cable is connected.

If the QR code is not recognised then close the app fully and open again and try scanning the code.